

MI - 1/4" PULSE METERS

The MI is a small capacity meter in the M Series range and is differentiated by its flow rate capabilities. It has the ability to handle a wide range of fluid viscosities with exceptional levels of repeatability and durability.



MIRSP-XH



MISSPH-X

Product Benefits

- Very compact size.
- Low flow capability with high resolution output.
- Meter accuracy is verified by a factory calibration check after which an individual metrology report is issued.
- Solid state Hall Effect Sensor or Reed Switch options.
- Low pressure drop allows for economical pump selection or gravity flow applications.
- Meter design minimises the number of wearable and replaceable parts and extends product life.
- Has IP54/NEMA13 protection. MISSPH-XY IP65-NEMA 9
- Flexibility of installation options (e.g. can be mounted horizontally or vertically; no flow conditioning required).

| | | | H.P. MODEL | |
|---|---|---|---|--|
| MODEL | MIRSP-XY | MISSP-XY | MISSPH-XY | MIASP-XY |
| METER TYPE | PULSE | PULSE | PULSE | PULSE |
| METER BODY MATERIAL | PPS | 316 STAINLESS STEEL | 316 STAINLESS STEEL | ALUMINIUM / PPS |
| WETTED COMPONENTS: ROTOR MATERIAL SHAFTS O'RING | 316 STAINLESS STEEL / CERAMIC 316 STAINLESS STEEL VITON | 316 STAINLESS STEEL / CERAMIC 316 STAINLESS STEEL VITON | 316 STAINLESS STEEL / CERAMIC 316 STAINLESS STEEL VITON | 316 STAINLESS STEEL / BRONZE 316 STAINLESS STEEL VITON |
| FLOW RATE RANGES (litres per hour/US gallons per hour) ABOVE 5 CPS BELOW 5 CPS | 2 to 100 / 0.53 to 26.4 5 to 100 / 1.32 to 26.4 | 2 to 100 / 0.53 to 26.4 5 to 100 / 1.32 to 26.4 | 2 to 100 / 0.53 to 26.4 5 to 100 / 1.32 to 26.4 | 2 to 100 / 0.53 to 26.4 5 to 100 / 1.32 to 26.4 |
| ACCURACY- WITHIN (OF READING) | +/- 1% | +/- 1% | +/- 1% | +/- 1% |
| REPEATABILITY | 0.03% | 0.03% | 0.03% | 0.03% |
| MAXIMUM VISCOSITY | 1000 Centipoise | 1000 Centipoise | 1000 Centipoise | 1000 Centipoise |
| MAXIMUM OPERATING PRESSURE | 500kPa/ 75 PSI/ 5 BAR | 1000kPa/ 150PSI/ 10BAR | 55160kPa/ 8000PSI/ 551BAR | 500kPa/ 75PSI/ 5BAR |
| PULSER TYPE | HALL EFFECT SENSOR OR REED SWITCH | HALL EFFECT SENSOR OR REED SWITCH | HALL EFFECT SENSOR OR REED SWITCH | HALL EFFECT SENSOR OR REED SWITCH |
| PULSES PER LITRE/US GALLON | 1000 / 3785.4 | 1000 / 3785.4 | 1000 / 3785.4 | 1000 / 3785.4 |
| MODEL DIMENSIONS METER BODY PORT FACE TO FACE | 50x50mm / 1.97"x1.97" 65mm / 2.58" | 50x50mm / 1.97"x1.97" 65mm / 2.58" | 86mm dia x 110mm h / 3.4" dia x 4.33" h 83mm / 3.26" | 50mm x 50mm / 1.97" x 1.97" 60mm / 2.36" |
| WEIGHT | 240g / 8.5oz | 600g / 21.2oz | 3.3kg / 116.5oz | 310g / 11oz |
| MAX. OPERATING TEMPERATURE | 80°C / 176°F | 120°C / 248°F | 120°C / 248°F | 80°C / 176°F |
| RECOMMENDED MESH STRAINER SIZE | 200 MESH | 200 MESH | 200 MESH | 200 MESH |

X-Port Size To order flowmeter you must replace 'X' with the relevant number. This number will determine the following specifications:
Y-Switch Operation (ie: Specify 'H' for Hall Effect or 'R' for Reed Switch)

Port Size:

1 = 1/4" BSP (F) ports
 2 = 1/4" NPT (F) ports
 1 = 1/4" BSP (F) ports
 2 = 1/4" NPT (F) ports] HP only with
] pulser cap

Calibrated In:

litres
 US gallons
 litres
 US gallons

Electrical Connections

1m/39" pulser fly lead
 1m/39" pulser fly lead
 20mm (F) Conduit Thread
 1/2" NPT (F)

PPS = Polyphenylene Sulfide Resins



MI - 1/4" PULSE METERS

TYPE MI - 1/4" PULSE METERS

Options & Accessories

| | VITON O-RING | PERFLUORO ELASTOMER | EPDM O-RING | HIGH TEMP ROTORS | HIGH VISCOSITY ROTORS | HALL EFFECT SENSOR | REED SWITCH | SOLVENT KIT | PPS ROTORS WITH HASTALLOY C SHAFTS | REMOTE MOUNTED LC DISPLAY | 4-20mA MODULE (REMOTE) |
|-----------------|--------------|---------------------|-------------|------------------|-----------------------|--------------------|-------------|-------------|------------------------------------|---------------------------|------------------------|
| MI - 1/4" METER | | | | | | | | | | | |
| M1RSP-XY | S | O | O | X | X | O | S | X | O | A | A |
| M1SSP-XY | S | O | O | X | X | O | S | X | X | A | A |
| M1SSPH-XY | S | O | O | X | X | O | S | X | X | A | A |
| M1ASP-XY | S | O | O | X | X | O | S | X | X | A | A |

S = Standard

O = Optional

X = Not Available

A = Accessory

Dimensions of High Pressure Meter

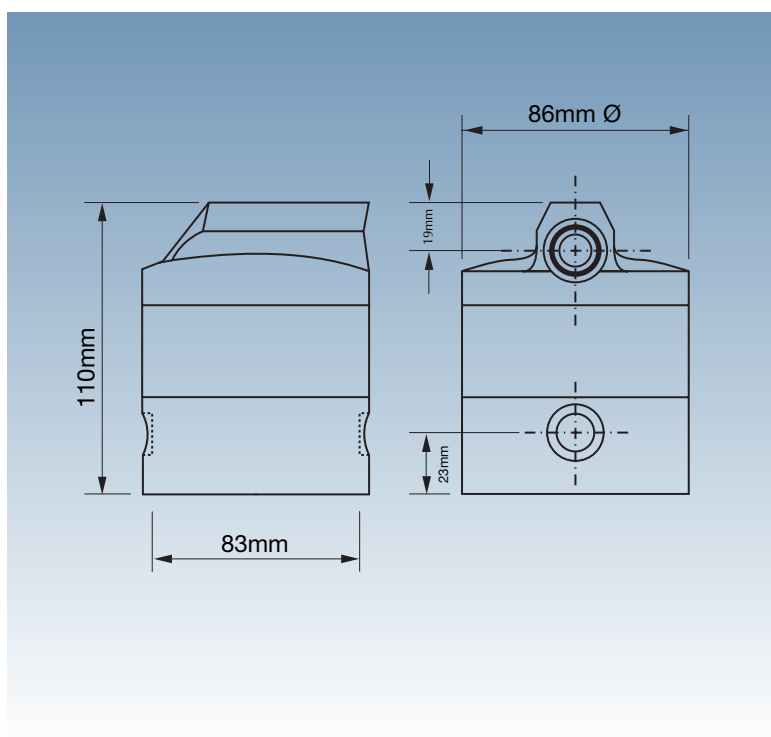

Standard Meter

